



Versatile Deep Cycle and Starter Batteries

Deep Cycle and Starter Batteries

Versatile Use. Verified Performance. Pure Value.

V-Force Deep Cycle and Starter Batteries Offer:

- More Power with Superior Battery Life
- The Heaviest Internal Construction in the Industry
- Rugged Cell Construction
- Unmatched Electrical Performance and Durability
- Envelope Separators to Prevent Plate Short-Circuiting and Shedding

Versatile Batteries for Your Industrial Demands:

V-Force Deep Cycle and Starter Batteries deliver the heaviest internal construction and durability in the industry ensuring solid performance, unmatched longevity, added power and superior reliability. With thicker plates than the competition and a rugged cell design, V-Force batteries deliver superior productivity and return on investment in the toughest applications. Combine ultimate performance with envelope separators that prevent plate short-circuiting and shedding, and you have a versatile industrial battery that lowers costs and keeps your business running.



Longer Life, Performance Like No Other

Proven Design Offers Pure Industrial Power, All the Time

Use V-Force Starter Batteries to increase efficiency and productivity in the most demanding applications. For use in IC forklifts, cars, vans, or trucks, versatile V-Force Starter Batteries will start your engine every time.

V-Force Starter Batteries tolerate the demands of high cycling, vibration and temperature-induced wear and tear with heavier and thicker plates, tough strap connections and wide diameter through the partition inner-cell connections.

- **High-Density Paste Material**

Delivers high performance and durability in tough applications

- **Calcium Alloys**

Delivers no-hassle, maintenance-free performance

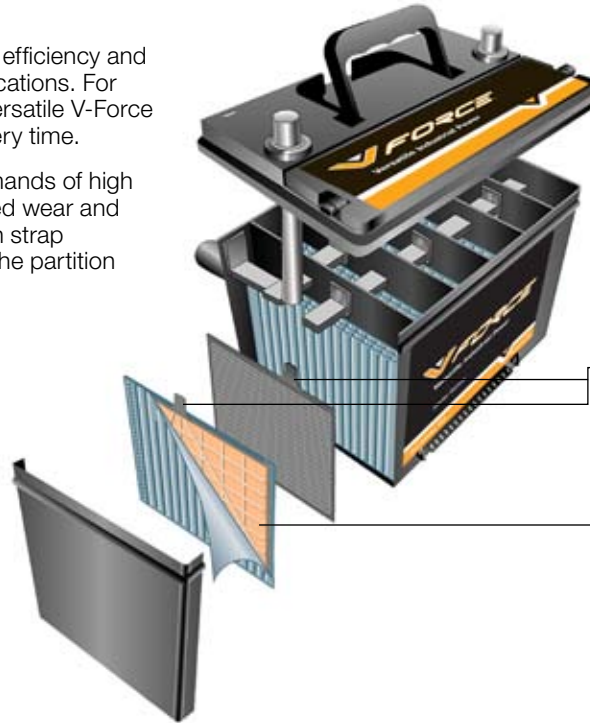

- **Integrated Handles**

Located on most batteries for easy handling

- **Centerline "Double Locking" Plate Design**

A "full frame" plate design allows for superior cranking power and durability

- **Envelope Separators**

Prevents plate short-circuiting and mousing for total reliability and durability

Starter Product Specifications

Part Number	BCI Group	CCA	RC Min	Inches			Millimeters			Weight		Terminal Style
				L	W	H	L	W	H	Lbs	Kgs	
Flooded 12 Volt												
345022	22NF	400	65	9.50	5.56	9.00	241	141	229	27	12	Type A
345024	24	550	85	10.25	6.75	9.00	260	172	229	39	18	Type A
345024-675	24	675	105	10.25	6.75	9.00	260	172	229	42	19	Type A
345024-675-01	24F	675	105	10.25	6.75	9.00	260	172	229	42	19	Type A
345025-500	25	500	65	9.63	7.00	8.88	245	178	226	35	16	Type A
345026-500	26/26R	500	65	8.25	6.81	8.25	210	173	210	29	13	Type A
345027-800	27	800	125	12.00	6.63	9.00	305	168	229	51	23	Type A
345029-340	29NF	340	90	13.00	5.50	8.88	330	140	226	39	18	Type A
345031-625	31	625	135	12.94	6.75	9.44	329	172	240	53	24	Type S
345031-775	31	775	170	12.94	6.75	9.44	329	172	240	59	27	Type A
345031-1000	31	1000	185	12.94	6.75	9.44	329	172	240	61	28	Type S
345034-675	34	675	105	10.25	6.81	8.19	260	173	208	42	19	Type A
345034-675-01	34R	675	105	10.25	6.81	8.19	260	173	208	42	19	Type A
345034-800	34/78	690	90	10.25	6.88	8.19	260	175	208	39	18	Type A/GM Side
345035-540	35	540	65	9.13	6.75	8.63	232	172	219	37	17	Type A
135898	45	500	70	9.50	5.69	9.06	241	145	230	30	14	Type A
345051-450	51	450	80	9.38	5.06	8.94	238	129	227	32	15	Type A
345051-450-OR	51R	450	80	9.38	5.00	8.75	238	127	222	28	13	Type A
345055-525	55	525	85	8.56	6.06	8.38	218	154	213	29	13	Type A
345058-600	58	600	80	9.31	7.25	7.00	237	184	178	32	15	Type A
345058-600-OR	58R	600	80	9.31	7.25	7.00	237	184	178	32	15	Type A
345065-650	65	650	100	12.06	7.44	7.56	306	189	192	42	19	Type A
345075-690	75	690	90	9.13	7.06	7.38	232	179	188	37	17	GM Side
345078-800	78	800	105	10.25	7.06	7.38	260	179	188	42	19	GM Side



Type A



Type S



GM Side

* Features depicted above only apply to flooded batteries

Sealed 12 Volt

136392 (Gel)	51	450	66	9.25	5.12	8.94	235	130	227	28	12.7	Type A
--------------	----	-----	----	------	------	------	-----	-----	-----	----	------	--------

More Performance, More Productivity... Less Maintenance

Whether it's an electric forklift, floor cleaning machine, scissor lift or electric vehicle, the versatile array of V-Force Deep Cycle Batteries work well in a variety of applications.

Experience less battery maintenance with V-Force Batteries. With our anchor-molded terminal design, V-Force Deep Cycle Batteries deliver best-available protection against problem-causing terminal corrosion and terminal short circuiting — allowing you to get more work done between charging cycles.

• Container Design

Provides more electrolyte above the battery plates so batteries can perform longer between water intervals – lowering your maintenance costs and improving overall ROI

• Heavy-Duty Construction

More weight means more lead and more lead means more performance and productivity

• Carrying Straps

Located on most batteries for easy handling

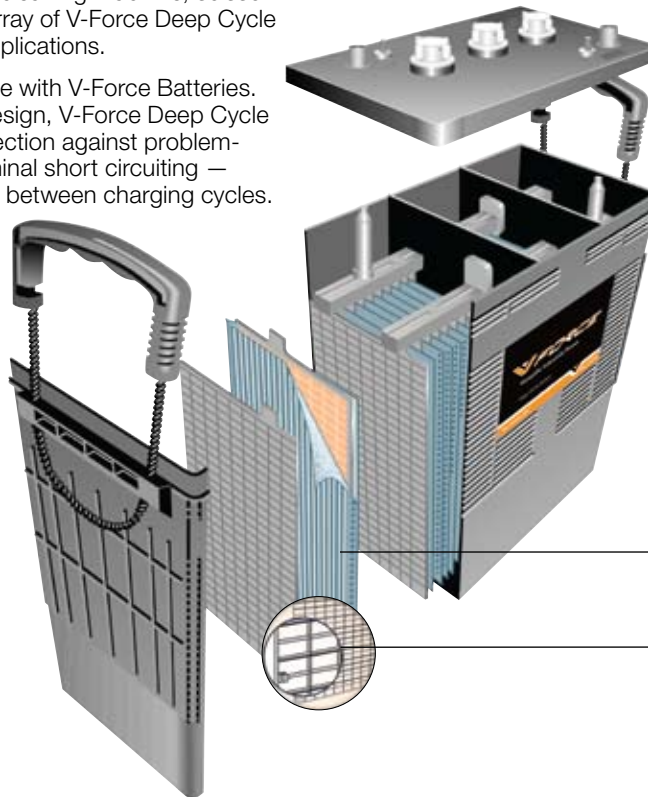

• Liquid Level Indicator

No mess, no guess system inspects electrolyte levels and signals when water is required

• Heat-Sealed Case and Cover Design

Provides rugged and long-lasting performance and reliability

• Rigid Connectors

A heavy-duty through-the-partition inner-cell connection, cast-on strap design and terminal post connectors work together to deliver maximum electrical efficiency and durability.

• Envelope Separators

Reduces maintenance and prevents failure due to short-circuiting and plate shedding

• Durable Plate Construction

Innovative grid architecture, inset lug position and advanced active paste material provides a durable, versatile battery for your industrial needs

Deep Cycle Product Specifications

Part Number	BCI Group	20 Hr. Rat (AH)	RC Min	Inches			Millimeters			Weight		Terminal Style	Liquid Level Indicator
				L	W	H	L	W	H	Lbs	Kgs		
Flooded 6 Volt													
345006-095	1	640	140 @ 25 A	9.08	6.91	8.75	231	176	222	31	14	Type A	No
345006-180	GC2	180	90 @ 75 A	10.25	7.13	10.75	260	181	273	55	25	Type S	No
345225	GC2	225	115 @ 75 A	10.25	7.13	10.75	260	181	273	63	29	Standard	No
345006-235	GC2	235	125 @ 75 A	10.25	7.13	10.75	260	181	273	68	31	Standard	No
345006-240	Euro GC	240	125 @ 75 A	9.63	7.50	10.75	245	191	273	65	29	Type A	No
345245	GC2H	245	145 @ 75 A	10.25	7.13	11.50	260	181	292	73	33	Standard	No
345006-250	901	250	140 @ 75 A	11.75	7.19	11.25	299	183	286	72	33	Standard	No
345006-275	901	275	155 @ 75 A	11.75	7.19	11.25	299	183	286	76	34	Standard	No
345006-305	902	305	175 @ 75 A	12.19	7.19	14.50	310	183	368	92	42	Standard	Yes
345006-325	902	325	196 @ 75 A	12.19	7.19	14.50	310	183	368	100	45	Standard	Yes
345006-350	903	350	210 @ 75 A	12.19	7.19	16.50	310	183	419	112	51	Standard	Yes
345006-395	903	395	225 @ 75 A	12.19	7.19	16.50	310	183	419	120	54	Standard	Yes
Flooded 8 Volt													
345012-085	24	85	160 @ 25 A	11.13	6.75	9.38	283	172	238	50	23	Standard	No
Flooded 12 Volt													
345012-085	24	85	160 @ 25 A	11.13	6.75	9.38	283	172	238	50	23	Standard	No
345012-115	27	115	170 @ 25 A	13.13	6.75	9.38	334	172	238	60	27	Standard	Yes
345012-140	31	140	200 @ 25 A	13.13	6.75	9.38	334	172	238	66	30	Standard	Yes
345012-155	920	155	72 @ 75 A	13.63	6.75	12.25	346	172	311	87	39	Type A & S	No
345012-185	921	185	95 @ 75 A	15.50	7.00	14.50	394	178	368	108	49	Standard	Yes
345012-210	921	210	110 @ 75 A	15.50	7.00	14.50	394	178	368	131	59	Standard	Yes

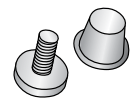

Standard



Type A



Type S

* Features depicted above only apply to flooded batteries. See back for Sealed Battery options.

V-Force Sealed AGM and Gel Batteries:

- Never need to water
- Non-Spillable — No Acid, No Corrosion
- Temperature and vibration resistant
- Able to orientate and use in any position

Deep Cycle Product Specifications (cont.)

Part Number	BCI Group	20 Hr. Rat (AH)	RC Min	Inches			Millimeters			Weight		Terminal Style
				L	W	H	L	W	H	Lbs	Kgs	
Sealed 6 Volt												
345006-200 (Gel)	GC2	200	100 @ 75 A	10.25	7.13	10.75	260	181	273	72	33	Standard
149455	27	220	195 @ 25 A	12.09	6.65	8.66	307	169	220	66	30	Inserted M6
Sealed 12 Volt												
345012-018-0S	12V - 18 Ah	18	10 @ 25 A	7.13	3.03	6.57	181	77	167	11.4	5	Type B1
345012-026-0S	12V - 26 Ah	26	14 @ 25 A	6.50	6.93	5.00	165	176	127	17.14	8	Type B1, Tabs
345012-055-0S	22NF	55	60 @ 75 A	9.00	5.43	9.50	229	138	241	37	16.7	Type Z
345012-055-0G (Gel)	22NF	55	65 @ 75 A	9.00	5.43	9.50	229	138	241	42	19	Type Z
345012-075	24	75	140 @ 75 A	10.25	6.65	9.19	260	169	234	51	23	Type Z
345012-100 (Gel)	27	95	180 @ 75 A	12.00	6.57	8.20	305	167	208	68	31	Standard
345012-100-0S	27	100	175 @ 25 A	12.09	6.65	9.19	307	169	234	60	27.7	Type Z
345012-100-SS	27	100	175 @ 25 A	12.09	6.65	9.19	307	169	234	60	27.7	Type S
345012-031-0G (Gel)	31	110	200 @ 25 A	13.36	6.81	9.20	340	173	234	82	37	Type S

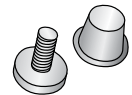

Standard



Type S

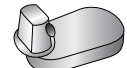

Type Z

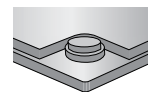

Inserted M6