

## 7" TOUCH

## Durable Construction with Intuitive Touchscreen Design

- 7" Touch Color LCD Display
- Intuitive menu navigation
- Customizable widgets\*
- Operator checklist with images\*
- Safety reminders\*
- Dynamic Coaching™ capable\*
- Platform that enables future growth
- Navigation buttons for glove usage
- Numeric keypad on screen for login or emergency operation
- Integrated proximity reader
- Strobe light indicator for impact protection

\*Features may vary by truck type

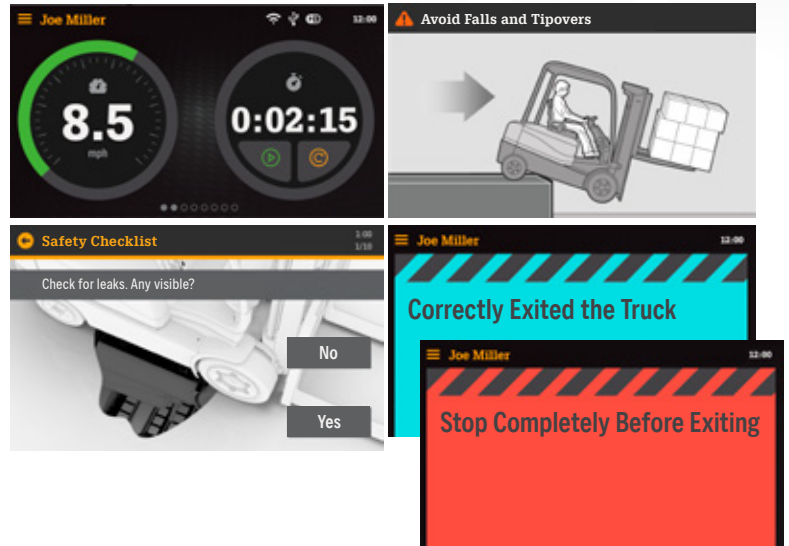

## InfoLink 7" Touch Display Module (HD6000)



## Additional Capabilities

- Multiple languages available
- Inspection questions - text with images
- Impact notifications on display
- Analyzer mode for live impact testing
- Two-way messaging
- Settings programmable through module
- Service menus accessible for system information
- Maintenance mode enabling capabilities

## 3" DISPLAY

## Durable Construction with Intuitive Design

- Four-line status display
  - Operator name
  - Time of day
- Five-button navigation
- Numeric keypad for login or emergency operation
- Optional proximity reader
- Alternative readers can be fitted to accommodate customer needs
- Optional plexi-glass cover
- Cellular option available

## InfoLink 3" Display Module (HD2500)



## Additional Capabilities

- Multiple languages available
- Inspection questions - text only
- Impact notifications on display
- Analyzer mode for live impact testing
- Two-way messaging
- Settings programmable through module
- Service menus accessible for system information
- Maintenance mode enabling capabilities

35 Pin Female Connector