

**CROWN**

# ST/SX 3000 SERIES

## Profile Sheet

Stackers



# ST 3000 Series

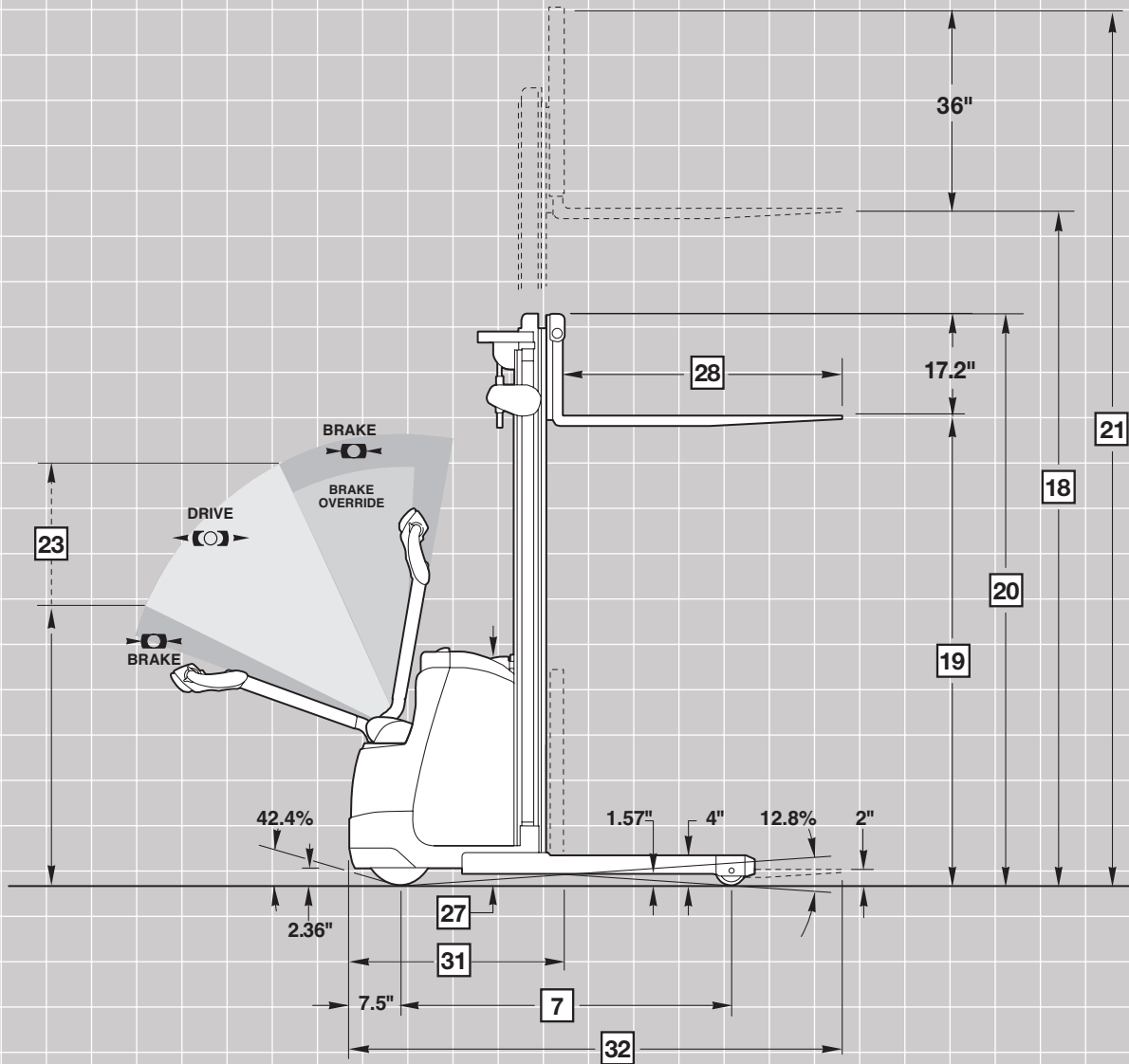
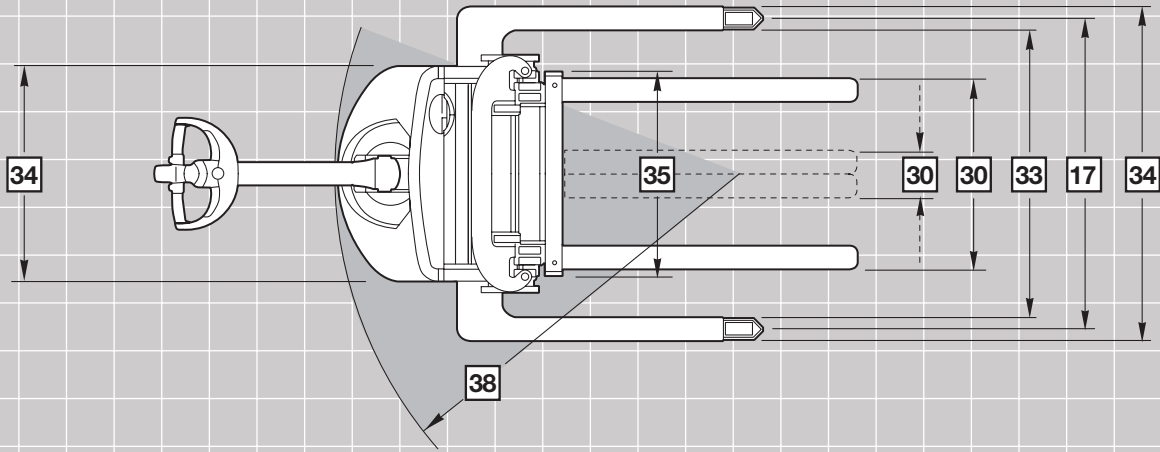

# ST 3000 Series

		Crown Equipment Corporation						
General Information	1	Manufacturer						
	2	Model		ST 3000N-20	ST 3000-20	ST 3000-20	ST 3000-20	
		Mast Type		in (mm)	TL-128 (3236)	TL-128 (3236)	TT-154 (3912)	TT-168 (4267)
	3	Power				Electric		
	4	Operator Type				Walkie		
	5	Load Capacity	Max	lb (kg)		2000 (907)		
	6	Load Center		in (mm)		24 (600)		
	7	Wheelbase		in (mm)		49 (1255)		
Tires	8	Weight Less Battery		lb (kg)	1775 (805)	1828 (829)	2004 (909)	2004 (909)
	13	Wheel Size Front (d x w)	Vulkollan	in (mm)	10 x 3.35 (254 x 85)			
			Rubber	in (mm)	10 x 4 (254 x 100)			
	14	Wheel Size Rear (d x w)	Vulkollan	in (mm)	4 x 2 (102 x 50)			
			Steel	in (mm)	4 x 2 (102 x 50)			
15	Additional Wheels Caster Wheel (d x w)	Poly	in (mm)	3.54 x 2 (90 x 50)				
16	Wheels Number (x=driven)	Front/Rear		1x / 2				
17	Track Width	Rear	in (mm)	Inside Straddle + 3 (76)				
Dimensions	18	Lift Height		in (mm)	127.4 (3236)	127.4 (3236)	154 (3912)	168 (4267)
	18a	Capacity at Lift Height	24" Load Center	lb (kg)	2000 (907)	2000 (907)	2000 (907)	2000 (907)
			26" Load Center	lb (kg)	1850 (840)	1850 (840)	1850 (840)	1850 (840)
			28" Load Center	lb (kg)	1720 (780)	1720 (780)	1720 (780)	1720 (780)
			30" Load Center	lb (kg)	1600 (725)	1600 (725)	1600 (725)	1600 (725)
	19	Free Lift	w/o Load Backrest	in (mm)	6 (152)	6 (152)	56 (1422)	56 (1422)
	20	Collapsed Height		in (mm)	83 (2108)	83 (2108)	73 (1858)	73 (1858)
	21	Extended Height	w/o Load Backrest	in (mm)	Lift Height + 17.2 (436)			
			w/Load Backrest	in (mm)	Lift Height + 36 (914)			
	22	Load Backrest Width	Load Backrest Height 36" (914) High	in (mm)	36 (914) / 42 (1067) / 48 (1219)			
	23	Tiller Arm Ht in Drive Position	Min/Max	in (mm)	31.1 (790) / 47.5 (1206)			
	24	Outrigger Height		in (mm)	4 (100)			
	25	Lowered Fork Height		in (mm)	2 (51)			
	27	Power Unit Height		in (mm)	32.28 (820)			
	28	Fork Lengths		in (mm)	36 (914) / 42 (1067) / 48 (1219)			
	29	Fork Dimensions	Thickness x Width	in (mm)	1.5 x 3 (38 x 76)			
	30	Width Across Forks	Adjustable Min/Max	in (mm)	6.57 - 24.8 (167 - 630)			
	31	Headlength		in (mm)	32.24 (819)	32.24 (819)	32.95 (837)	32.95 (837)
	32	Overall Length			Headlength + Fork Length			
	33	Inside Straddle		in (mm)	29.3-36 (744-914)	38-50 (965-1270)	38-50 (965-1270)	38-50 (965-1270)
34	Overall Width	Front	in (mm)	28.03 (712)				
		Rear	in (mm)	Inside Straddle + 6 (152)				
35	Fork Carriage Width		in (mm)	26.57 (675)				
36	Ground Clearance	w/Load below Mast	in (mm)	1.57 (40)				
37		Center Wheelbase	in (mm)	1.57 (40)				
38	Turning Radius		in (mm)	56.73 (1446)				
39	Length w/Outriggers		in (mm)	60.28 (1536)				
43	Gradeability	w/wo Load, 60 min Rating	%	2.4 / 4.5				
		w/wo Load, 30 min Rating	%	4.9 / 9.1				
		w/wo Load, 5 min Rating	%	8.4 / 15.7				
44	Max Gradeability	w/wo Load, 5 min Rating	%	8.4 / 15.7				
45	Service Brake			Electric				
Battery and Charger	46	Maximum Battery Box	L x W x H	in (mm)	7.28 x 25.55 x 24.13 (185 x 649 x 613) (w/No Clearance)			
	47	Battery Voltage (Nominal Capacity 6 Hour Rating)	4x Automotive Starter*	V/Ah	24 / 87			
			2x 12v MF	V/Ah	24 / 95			
			4x Semi-industrial	V/Ah	24 / 156			
			4x 6v MF	V/Ah	24 / 195			
	48	Type of Controller	Drive		Transistor			
	49	Battery Weight	4x Automotive Starter	lb (kg)	128 (58)			
			2x 12v MF	lb (kg)	132 (60)			
			4x Semi-industrial	lb (kg)	220 (100)			
			4x 6v MF	lb (kg)	267 (121)			
50	Internal Charger*		V/amp	120/30				

English conversions are approximations. Metric conversions should be done to find true values.

\* Standar Equipment

# SX 3000 Series

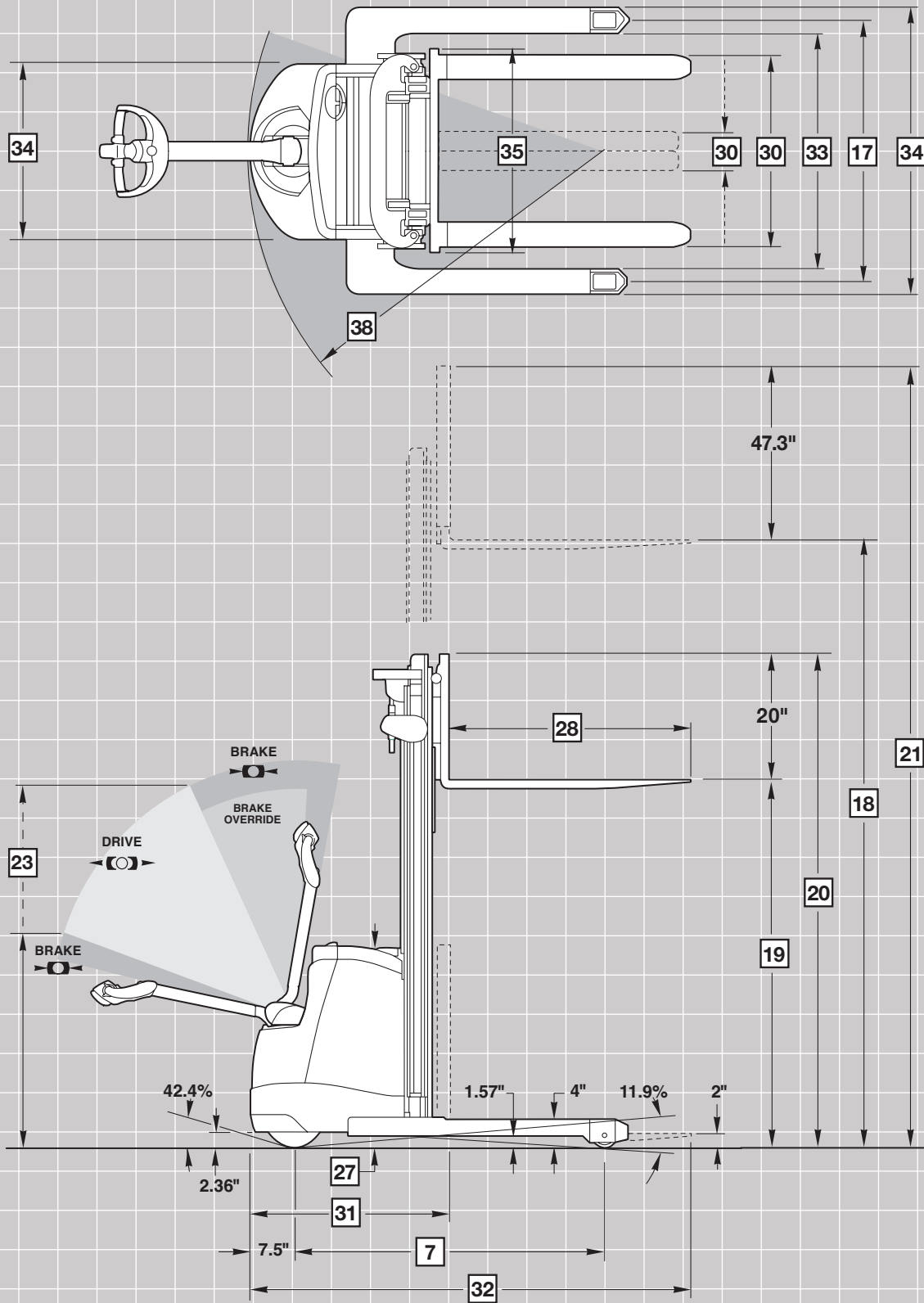

# SX 3000 Series

		<b>Crown Equipment Corporation</b>			
<b>General Information</b>	1	<b>Manufacturer</b>			
	2	<b>Model</b>		SX 3000-30	SX 3000-30 SX 3000-30
	3	<b>Mast Type</b>		in (mm)	TL-128 (3236) TT-154 (3912) TT-168 (4267)
	4	<b>Power</b>			Electric
	5	<b>Operator Type</b>			Walkie
	6	<b>Load Capacity</b>	Max	lb (kg)	3000 (1361)
	7	<b>Load Center</b>		in (mm)	24 (600)
	8	<b>Wheelbase</b>		in (mm)	53.6 (1362)
<b>Tires</b>	13	<b>Wheel Size Front (d x w)</b>	Vulkollan	in (mm)	10 x 3.35 (254 x 85)
	14	<b>Wheel Size Rear (d x w)</b>	Rubber	in (mm)	10 x 4 (254 x 100)
	15	<b>Additional Wheels Caster Wheel (d x w)</b>	Poly	in (mm)	3.54 x 2 (90 x 50)
	16	<b>Wheels Number (x=driven)</b>	Front/Rear		1x / 2
	17	<b>Track Width</b>	Rear	in (mm)	Inside Straddle + 4 (102)
<b>Dimensions</b>	18	<b>Lift Height</b>		in (mm)	127.4 (3236) 154 (3912) 168 (4267)
	18a	<b>Capacity at Lift Height**</b>	24" Load Center	lb (kg)	3000 (1361) 3000 (1361) 2500 (1134)
			26" Load Center	lb (kg)	2700 (1225) 2700 (1225) 2200 (998)
			28" Load Center	lb (kg)	2500 (1134) 2500 (1134) 2000 (907)
			30" Load Center	lb (kg)	2250 (1020) 2250 (1020) 1750 (795)
	19	<b>Free Lift</b>	w/o Load Backrest	in (mm)	6 (152) 53 (1347) 53 (1347)
	20	<b>Collapsed Height</b>		in (mm)	83 (2108) 73 (1858) 73 (1858)
	21	<b>Extended Height</b>	w/o Load Backrest	in (mm)	Lift Height + 20 (510)
			w/Load Backrest	in (mm)	Lift Height + 47.3 (1202)
	22	<b>Load Backrest Size</b>		in (mm)	47.3 (1202) H x 32.7 (832) W
	23	<b>Tiller Arm Ht in Drive Position</b>	Min/Max	in (mm)	31.1 (790) / 47.5 (1206)
	24	<b>Outrigger Height</b>		in (mm)	4 (100)
	25	<b>Lowered Fork Height</b>		in (mm)	2 (50)
	27	<b>Power Unit Height</b>		in (mm)	32.28 (820)
	28	<b>Fork Lengths</b>		in (mm)	36 (914) / 42 (1067) / 48 (1219)
	29	<b>Fork Dimensions</b>	Thickness x Width	in (mm)	1.5 x 4 (38 x 102)
	30	<b>Width Across Forks</b>	Adjustable Min/Max	in (mm)	10 - 30.93 (253.6 - 785.6)
	31	<b>Headlength*</b>		in (mm)	34.02* (869*) 34.72* (887*) 34.72* (887*)
	32	<b>Overall Length</b>			Headlength + Fork Length
	33	<b>Inside Straddle</b>		in (mm)	38-50 (965-1270)
34	<b>Overall Width</b>	Front	in (mm)	28.03 (712)	
		Rear	in (mm)	Inside Straddle + 8 (204)	
35	<b>Fork Carriage Width</b>		in (mm)	31.89 (810)	
36	<b>Ground Clearance</b>	w/Load below Mast	in (mm)	1.57 (40)	
37		Center Wheelbase	in (mm)	1.57 (40)	
38	<b>Turning Radius</b>		in (mm)	61.14 (1553)	
39	<b>Length with Outriggers</b>		in (mm)	65 (1651)	
<b>Gradeability</b>	43	<b>Gradeability</b>	w/wo Load, 60 min Rating	%	2.6 / 5.2
			w/wo Load, 30 min Rating	%	4.4 / 8.7
	44	<b>Max Gradeability</b>	w/wo Load, 5 min Rating	%	9.5 / 19.4
45	<b>Service Brake</b>			Electric	
<b>Battery and Charger</b>	46	<b>Maximum Battery Box</b>	L x W x H	in (mm)	9.1 x 26.4 x 23.62 (230 x 670 x 600) (w/No Clearance)
	47	<b>Battery Voltage (Nominal Capacity 6 Hour Rating)</b>	4x 6v MF***	V/Ah	24 / 195
			300 Industrial Battery	V/Ah	24 / 300
	48	<b>Type of Controller</b>	Drive		Transistor
	49	<b>Battery Weight</b>	4x 6v MF	lb (kg)	267 (121)
			300 amp hour Industrial	lb (kg)	360-710 (163-322)
50	<b>Internal Charger***</b>		V/amp	120/30	

\* Add 2.24" (57 mm) for Sideshift Option.

\*\*Deduct 300 lb for Sideshift Option.

\*\*\* Standard Equipment.

English conversions are approximations. Metric conversions should be done to find true values.

## Aisle Planning Guide

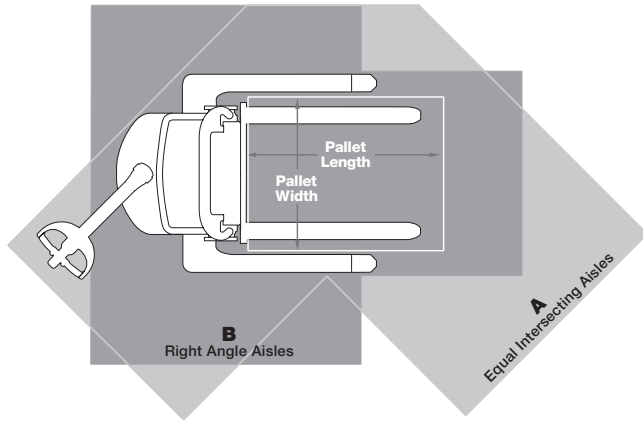

### ST 3000 – Right Angle and Intersecting Aisle

Pallet Width		Pallet Length									
		30		36		40		42		48	
		A	B	A	B	A	B	A	B	A	B
36	in	57.6	62.9	57.6	62.9	57.6	62.9	57.6	62.9	57.6	68.4
	mm	1463	1599	1463	1599	1463	1599	1463	1599	1463	1738
40	in	60.9	64.0	60.9	64.0	60.9	64.0	60.9	64.0	60.9	68.6
	mm	1546	1625	1546	1625	1546	1625	1546	1625	1546	1625
42	in	62.5	64.5	62.5	64.5	62.5	64.5	62.5	64.5	62.5	68.7
	mm	1588	1638	1588	1638	1588	1638	1588	1638	1588	1746
48	in	67.5	69.0	67.5	69.0	67.5	69.0	67.5	69.0	67.5	72.0
	mm	1715	1752	1715	1752	1715	1752	1715	1752	1715	1829

Add 6" to all aisle dimensions for maximum maneuverability.

### SX 3000 – Right Angle and Intersecting Aisle

Pallet Width		Pallet Length									
		30		36		40		42		48	
		A	B	A	B	A	B	A	B	A	B
36	in	61.2	67.1	61.2	67.1	61.2	67.1	61.2	67.1	61.2	67.8
	mm	1554	1704	1554	1704	1554	1704	1554	1704	1554	1722
40	in	64.5	68.1	64.5	68.1	64.5	68.1	64.5	68.1	64.5	68.1
	mm	1638	1730	1638	1730	1638	1730	1638	1730	1638	1730
42	in	66.1	68.6	66.1	68.6	66.1	68.6	66.1	68.6	66.1	68.6
	mm	1680	1743	1680	1743	1680	1743	1680	1743	1680	1743
48	in	71.1	72.9	71.1	72.9	71.1	72.9	71.1	72.9	71.1	72.9
	mm	1807	1851	1807	1851	1807	1851	1807	1851	1807	1851

Add 6" to all aisle dimensions for maximum maneuverability.  
Add 2" if sideshift option is used.



**Crown Equipment Corporation**  
New Bremen, Ohio 45869 USA  
**Tel** 419-629-2311  
**Fax** 419-629-3796  
crown.com

You can count on Crown to build lift trucks designed for safe operation, but that's only part of the safety equation. Crown encourages safe operating practices through ongoing operator training, safety-focused supervision, maintenance and a safe working environment. Go to [crown.com](http://crown.com) and view our safety section to learn more.

Because Crown is continually improving its products, specifications are subject to change without notice.

Crown, the Crown logo, the color beige, the Momentum symbol, Access 1 2 3, InfoPoint, InfoLink and X10 Handle are trademarks of Crown Equipment Corporation.

Copyright 2012 Crown Equipment Corporation  
SF18788 01/12  
Printed in U.S.A.